

NEW!

**If only there
was a way
to wall off...
...There is!**

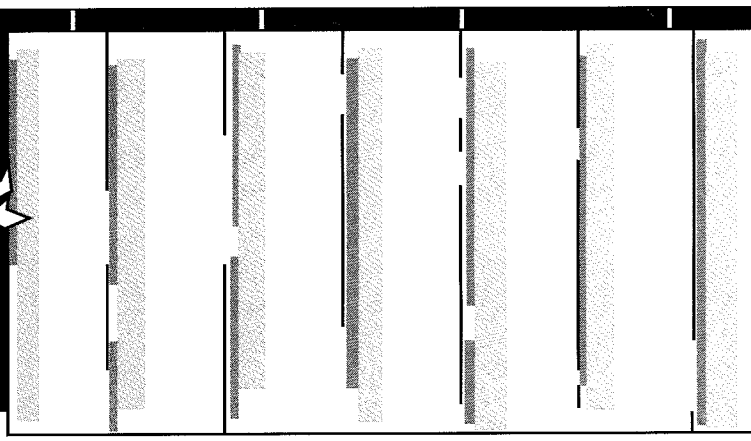
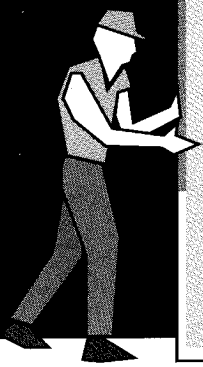

CUSTOM CURTAIN WALLS

A Simple, Easy, and Inexpensive Method of Forming Portable, Isolated Areas for Privacy, Cleanliness, Safety, Environmental Control, Etc.

It's up to you! If you need a temporary wall for any number of reasons, the Rotary Products Custom Curtain Wall system can fill your needs. Ideal for manufacturing facilities, warehouses, offices, schools, institutions, wherever control over any area is needed. Rotary Products Custom Curtain Walls are easy to install and can be set up by your own personnel without using special tools or skills. They can be designed to suspend from the ceiling or roof bracing structure, mount to walls, or hang from a free standing support system. Curtain material can be stretched over panels or hung from track that allows them to be rolled out of the way when not in use. Form cubicles, booths, partitions or temporary walls. A wide variety of hardware pieces can be used to provide any shape needed to enclose a space. There are straight-angle corners, curved corners, rolling-track sections, t-connections, floor-, ceiling-, and wall-mounting brackets and various connectors to join hardware pieces together. All hardware has rust and corrosion protection to ensure long life and provide easy rolling for years to come.

The curtain material can be made from a wide selection of materials such as translucent and opaque plastics, fire retardant cloth, vinyl's, canvas, neoprene rubber, etc. Clear PVC can be sewn into curtain to make windows.

Remember, your imagination and needs are the only limits in designing a Rotary Custom Curtain Wall. Let your Rotary Products representative recommend the best design and materials to suit your application.

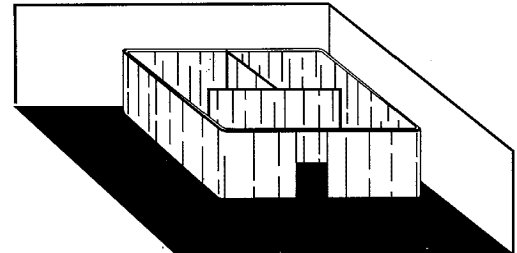

Full Enclosures

Rotary Custom Curtain walls create new, useable areas out of larger, unmanageable spaces making them more functional. Any size of work area can be created with movable or retractable panels that can be added or deleted at any time.

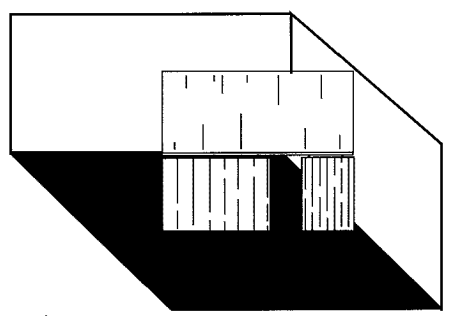

Partitions

Section off large buildings like warehouses and factories for environmental control, safety, or noise control. Permanent top panels for high ceilings with free standing sliding panels below allowing usage and accessibility.

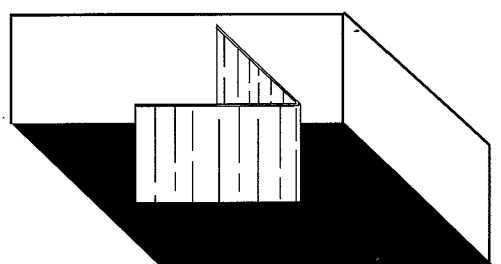

Isolated Areas.

Any size of small work area can be created within a larger area quickly, and easily. Sections can be added or deleted at any time with movable panels. Curtains can be rolled back or removed when not needed.



Rotary Products, Inc.
202 East High Street
P.O. Box 370
Ashley, OH 43003
Phone: 800-457-5251 or (740) 747-2623
Fax: (740) 747-2188

HARDWARE FOR CUSTOM CURTAIN WALLS

TRACK AND ACCESSORIES

The basis of the Rotary Custom Curtain Wall System is its unique hardware system. There are three basic elements to the system, and a wide variety of different methods of mounting these basic elements. The basic elements include: 1. straight and curved track sections, 2. track splices or track joiners, and 3. track trolleys that hold the curtain material and move inside the track. Another basic piece of the hardware system is the end stop. The end stops are installed in the track to stop the trolleys from traveling out the end of the track or to stop the trolley at a designated point.

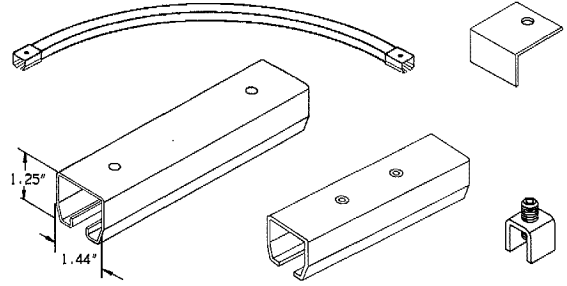

TROLLEY SYSTEMS

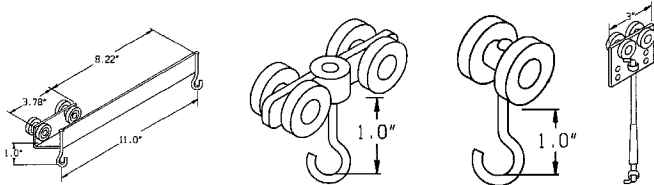

Trolley systems are available with either nylon wheels or steel ball bearing wheels. The nylon wheels are designed for systems that use light curtain materials, the steel ball bearing wheels are the better system for heavier curtains. The wheel design allows the curtain to roll easily and close fully. The trolleys are available in a variety of designs with different wheel configurations, curtain hanger hooks, with or without bumper protectors, designs that allow a curtain to overlap and trolleys to be pulled by a rope to prevent damage to the curtain material in certain applications.

THE TRUE VERSATILITY OF THE CUSTOM CURTAIN WALL SYSTEMS ARE THE MANY WAYS THE HARDWARE CAN BE MOUNTED OR SUSPENDED...

...SUSPEND & HANG IT, MOUNT IT TO YOUR WALLS, STAND IT ON THE FLOOR OR CLAMP IT TO YOUR ROOF SUPPORTS. THE CUSTOM CURTAIN WALL SUPPORTING SYSTEM IS EASY AND FUNCTIONAL!

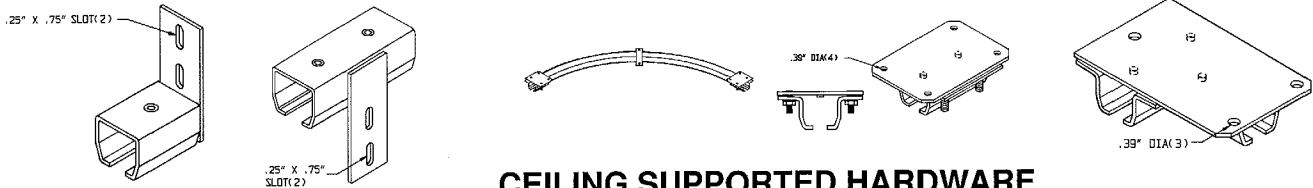

WALL MOUNTING HARDWARE

Wall mounting hardware is used to mount track system to adjacent walls, or where the track ends into a wall. The mounting brackets are either above or below the mount for choice of mounting close to ceiling or closer to door height. There are brackets, splices and end mounts.

CEILING SUPPORTED HARDWARE

Ceiling supports are designed to have the entire custom curtain wall system attached to the ceiling in offices and other low ceiling areas. The hardware is designed so that track can be attached before or after the hardware is attached to the ceiling. There are no screws or nuts protruding above the mounting plates. No spacers or clearance holes are needed to work with the hardware. The mounting plates have stud ends that are used to lock the track to the support hardware. There are curved track, splices, brackets, right angle and three-way intersection brackets all with the ceiling support plates.

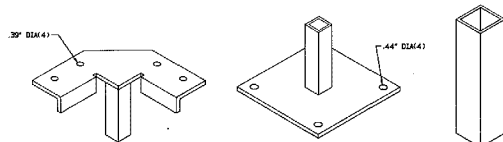

FLOOR SUPPORT HARDWARE.

This hardware is designed to allow you to support parts of or the entire curtain wall system from the floor. The support columns are 1 1/4" square, 12 gauge steel tubes that are in 6', 7', 8', 9', 10' lengths. Base plates for the support tubes are 12" squares that are made from 1/4" thick steel plates. There are floor support curved track, splices, brackets, right angle and three-way brackets, splice/floor and corner brackets.

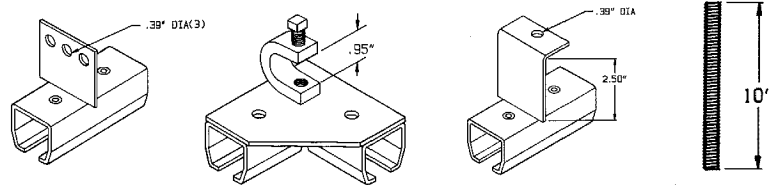

BEAM FLANGE SUPPORT HARDWARE

The beam flange support hardware is designed to allow attachment to edges of roof trusses, beams or channels with edge clamps and set screws. The edge clamps can be rotated for alignment to the support structure. Brackets, splices, right angle and three-way brackets are available with the beam flange clamp system.

THREADED ROD SUPPORT HARDWARE

The threaded rod support hardware is designed for use when there are no easily accessible structures near the area you want to hang the track. The rod can be mounted to any structure near the ceiling and significantly above the track system. The rods are available in 10' long sections and can be joined together with coupling nuts. Edge clamps like those used in the flange clamp system can be used to clamp rods to ceiling beams, trusses, etc. Splices, brackets, right angle and three-way brackets are available.

DOUBLE TRACK HARDWARE

Support hardware for double track systems are available in all of the different styles listed on this page. Contact the factory if you need support hardware for double tracks.

TRACK SUPPORT HARDWARE SYSTEMS CAN BE A MIXTURE OF STYLES TO MEET THE NEEDS OF YOUR PARTICULAR DESIGN.