

EQUIPMENT SCHEDULE

ITEM NO	QTY	EQUIPMENT CATEGORY	MANUFACTURER	MODEL NUMBER	EQUIPMENT REMARKS
1	1	SCALE, RECEIVING	HOBART	HBR300-1	MOBILE
2	1	REPELING TABLE	ADVANCE TABCO	TKAS-244	MOBILE
3	1	DRAWER ASSEMBLY COMPLETE	ADVANCE TABCO	SS-2020	MOBILE
4	3	DOLLY, DISHRACK	CAMRO	CD2020	MOBILE
5	4	DISH STORAGE DOLLY	GRES COR	501-10-240	MOBILE
6	1	CLEAN DISHTABLE	ADVANCE TABCO	DTC-572-22R	PROVIDE REEL RINSE BACK PLATE
6.1	3	HOSE REEL WITH GUN	FISHER	29399	
7	1	WATER HEATER, BOOSTER, GAS	HOBART	H140+BUILDUP	
8	1	DISHWASHER HOOD	HOBART	VCH-3624	
9	1	WASHER, RACK CONVEYOR	HOBART	C44A-G-LR	
10	1	DISPOSER, CONTROL CENTER	N-SINK-ERATOR	CC-2020-3	
11	1	DISPOSER, GARBAGE	N-SINK-ERATOR	SS-300-15-SHORT	
12	1	PRE-RINSE FAUCET, WALL MOUNT	FISHER	2210-WB	
13	1	CANTILEVERED DOUBLE RACK SHELF	ADVANCE	CUSTOM	
14	1	SOILED DISHWASHER, U SHAPE	ADVANCE TABCO	DTS-U30-108L	
15	1	SINK, SOAK	DUKE MANUFACTURING	SKS20LD	MOBILE
16	2	CART, BANQUET SERVICE	LAKEVIEW MARS	594	MOBILE
17	2	DIRTY DISH RACKS MOBILE	ADVANCE TABCO	MC-1848R	
18	3	SINK, HAND, WALL MOUNT	ADVANCE TABCO	7-PS-18	
19	1	CHEMICAL STORAGE CABINET	INTERSTATE PRODUCTS	PEST-32	
20	1	FAUCET, UTILITY	FISHER	8261	
21	1	SINK, MOP	ADVANCE TABCO	9-OP-28	
22	1	SHELVING, WALL MOUNTED	ADVANCE TABCO	K-245	
24	2	DRY STORAGE SHELVING	ADVANCE TABCO	EG-2448	
25	1	RACK, CAN	ADVANCE TABCO	GR10-54	
26	6	DRY STORAGE SHELVING	ADVANCE TABCO	EG-1848	
27	2	COFFEE URN, BANQUET SERVICE	FETCO	CBS-71AC(3)	(3) MOBILE DISPENSERS
28	1	ICED TEA/HOT TEA BREWER	FETCO	TBS-71AC(3)	(3) MOBILE DISPENSERS
29	2	ICE MAKER	ICE-O-WAIC	ICCB080HR/ERC2062/RTC345-404	REMOTE CONDENSER
29.1	1	DUAL PORT FILTRATION SYSTEMS	CUNO WATER FILTER	MODEL 5	
30	1	BNL, ICE	ICE-O-WAIC	B150SP	MOBILE
31	1	CART, ICE TRANSPORT	CAMRO	CS200TB	MOBILE
32	1	FILLER, GLASS	FISHER	98388	
34	1	POT RACK, WALL MOUNT	ADVANCE TABCO	PS-10-96	
35	2	FAUCET, WALL MOUNT	FISHER	3253	
36	1	SINK, SQUELTER	ADVANCE TABCO	9-43-72-24RL	
37	1	RACK, POT & PAN (MOBILE)	ADVANCE TABCO	MC-1848R	MOBILE
38	1	OVEN, CONNECTION, GAS	VULCAN-HART	VO666D	
39	1	FILLER, KETTLE & POT	FISHER	2740	
40	1	EXHAUST HOOD W/ PERF FRONT MUA	HOOD DEPOT	SW-4824 PF	
41	-	OPEN NUMBER	-	-	
42	1	RANGE W/CONV, OVEN BASE	VULCAN-HART	V436C	MOBILE
42.1	1	RANGE, HEAVY DUTY, GAS	VULCAN-HART	V636	MOBILE
43	1	BROILER, INFRARED	VULCAN-HART	VSB3BR	
44	1	BROILER, UNDER-FIRED/GAS	VULCAN-HART	HGB34	MOBILE
45	1	STEAMER, CONNECTION	GREEN	HY-65S	
46	1	TILT SKILLET	VULCAN-HART	VG30	
47	2	FRYER BATTERY, GAS W/FILTER	FRYMASTER	HS5SC/TW-1	PROVIDE FOOT PRINT FILTRATION SYSTEM
48	1	REFRIGERATOR, SANDWICH/SALAD PREP	TRUE FOOD SERVICE	TSSU-48-12	
49	1	CUTTER/MIXER, VERTICAL	HOBART	HCM300+BUILDUP	
49.1	1	UTILITY SPRAY	FISHER	2280	
50	1	REFRIGERATOR/FREEZER, DUAL-TEMP	TRUE FOOD SERVICE	T-230T	MOBILE
51	1	SLICER, FOOD	HOBART	2912-BUILDUP	MOBILE
52	1	SLICER STAND (MOBILE)	ADVANCE TABCO	VSS-302	MOBILE
53	1	SHELF, WALL MOUNT	ADVANCE TABCO	WS-12-96	
54	1	TABLE, PREP W/ SINK AND DECK FAUCET	ADVANCE TABCO	DL-30-96	
54.1	1	FAUCET, DECK MOUNT	FISHER	3512	
55	1	WALK-IN COOLER/FREEZER	AMERICAN PANEL	-	
56	2	RACK, UTILITY	GRES COR	207-LA-12-AC	
57	6	COOLER SHELVING	ADVANCE TABCO	EG1848	
57.1	1	SHELVING, WIRE	ADVANCE TABCO	EG-1842	
58	4	FREEZER SHELVING	ADVANCE TABCO	EG1848	
58.1	2	SHELVING, WIRE	ADVANCE TABCO	EG-1842	
59	1	DRAWER ASSEMBLY COMPLETE	ADVANCE TABCO	SS-2020	
60	1	RACK, POT & PAN	ADVANCE TABCO	GC-120	
61	1	DROP-IN, HOT WELLS	DELFIELD	8745	
61.1	1	FAUCET, DECK MOUNT	FISHER	3012	
62	1	TABLE, WORK	ADVANCE TABCO	VSS-3610	
62.1	1	TABLE, OVERSHELF W/ MICROWAVE SHELF	ADVANCE TABCO	MC-12-96	
63	1	OVEN, MICROWAVE	AMANA APPLIANCES	RCSI1DPS	
64	2	BNL, INGREDIENT	CAMRO	IB27	
65	1	TABLE, OVERSHELF	ADVANCE TABCO	PT-12R-60	
66	1	TABLE, BAKERS	ADVANCE TABCO	BG1-305	
67	1	MIXER, FLOOR	HOBART	D300+BUILDUP	
68	1	COOLING RACK	GRES COR	207-LA-12-AC	
69	2	CART, BANQUET SERVICE	F.W.E.	P-120	
70	1	CABINET, MOBILE, WARMING & HOLDING	F.W.E.	UHS-120	
71	2	CABINET, MOBILE, REFRIGERATED	F.W.E.	SR-30	
72	2	BUFFET ENTREE (CARVING) STATION	DELFIELD	KRB	
73	2	BUFFET HOT FOOD-SOUP STATION	DELFIELD	KH-4	
74	2	BUFFET BUFFET SHIELD	DELFIELD	KD-60	
75	2	BUFFET/CAETERA, COLD FOOD STATION	DELFIELD	KCSC-60-B	
76	2	BUFFET/CAETERA, COLD FOOD SHIELD	DELFIELD	KD-60	
77	2	BUFFET FLAT TOP	DELFIELD	KC-50	
78	2	BUFFET DISPLAY, TRIPLE DECK	DELFIELD	KB-50	
79	4	COFFEE AND TEA DISPENSERS	FETCO	LBD-6C	INCLUDED WITH ITEM 27 AND 28
80	2	BAR, PORTABLE	F.W.E.	BBC-66	MOBILE
81	1	FLOOR TROUGH	ADVANCE TABCO	FTG-1260	
82	1	FLOOR TROUGH	ADVANCE TABCO	FTG-1248	
83	2	CUP AND SAUCER DISPENSER	APW WOTT	CRS-2020-5	MOBILE

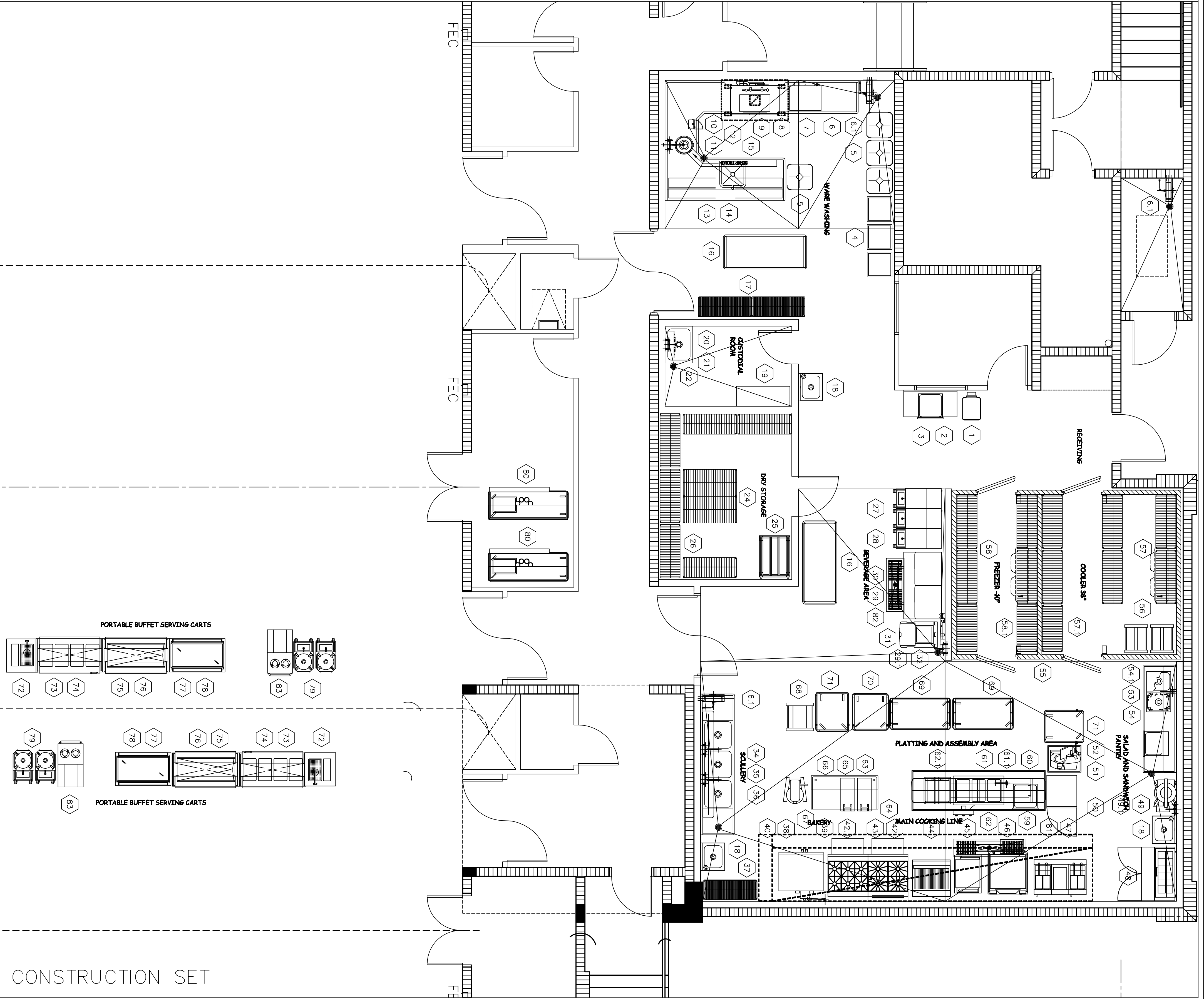

CONSTRUCTION SET

SHEET: <b>FS-1</b> 1 OF 6	TITLE: <b>FOOD SERVICE EQUIPMENT PLAN</b>	PROJECT: <b>MIRAMAR CULTURAL ARTS PARK          MIRAMAR TOWN CENTER          MIRAMAR, FLORIDA</b>	SEAL: <b>AA C001388</b>		COMMERCIAL KITCHEN PLANNERS www.cooking.com
	JOB NO: <b>0444</b>	DATE: APRIL 16., 2007 DRAWN BY: DC CHECKED BY: MC	REVISIONS:		

ALL DESIGNS AND DETAILS INDICATED OR REPRESENTED BY THIS DRAWING ARE FOR USE ON AND IN CONJUNCTION WITH THE SPECIFIED PROJECT. THIS IS THE PROPERTY OF CARTAYA AND ASSOCIATES ARCHITECTS, P.A. AND SHALL NOT BE USED OR REPRODUCED IN WHOLE OR IN PART WITHOUT WRITTEN PERMISSION FROM A PRINCIPAL OF THE FIRM OR BE LIABLE FOR THE FULLEST LEGAL RESCOURSE. THE CONTRACTOR SHALL VERIFY ALL EXISTING CONDITIONS AND DIMENSIONS AND NOTIFY THIS OFFICE OF ANY DISCREPANCIES PRIOR TO THE EXECUTION OF THE WORK. WRITTEN DIMENSIONS TAKE PRECEDENCE OVER SCALED DIMENSIONS.